

SSA-EB1PLx-0DEx Series Lighted Emergency Stop Button with ISD

Instruction Manual

Original Instructions
215157 Rev. B
28 April 2021
© Banner Engineering Corp. All rights reserved



215157

Contents

1 Product Overview	3
1.1 Models	3
1.2 Important... Read this before proceeding!	3
1.3 Emergency Stop Considerations	4
1.4 Overview	4
2 Installation Instructions	5
2.1 Mechanical Installation	5
2.2 Installation Requirements	5
2.3 Output Signal Switching Devices (OSSDs) and External Device Monitoring (EDM)	6
2.3.1 Fault-Tolerant Output Feature	6
2.4 Wiring for a Single E-Stop	7
2.4.1 Wire the Device in Series	7
2.4.2 Wire the Device in Series Using the Quick Disconnect (QD)	8
2.5 Checkout	10
2.6 Resetting the Inputs	11
2.7 In-Series Diagnostic (ISD) Information	11
2.8 Installing the Silicone Cover	12
3 Specifications	13
3.1 Dimensions	14
4 Accessories	15
4.1 Cordsets	15
4.2 Brackets	17
4.3 Adapters and Other Accessories	17
4.4 Safety Controllers	17
4.5 Universal (Input) Safety Modules	18
4.6 Pre-Installed Shroud	18
5 Product Support and Maintenance	20
5.1 Maintenance and Service	20
5.2 Status Indicators	20
5.3 EU Declaration of Conformity (DoC)	20
5.4 Information Available Using ISD	20
5.5 Contact Us	22
5.6 Banner Engineering Corp. Limited Warranty	22

1 Product Overview

SSA-EB1PLx-0Dx Series Lighted Emergency Stop Button with ISD

Figure 1. 30 mm mount model

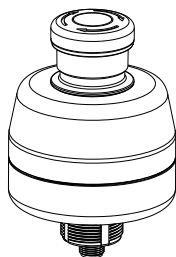
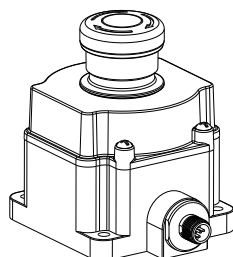

Figure 2. Flush mount model



- Rugged design; easy installation with no assembly or individual wiring required
- Push-to-stop, twist-to-release, or pull-to-release operation per EN 60947-5-5
- Latching design complies with ISO 13850; direct (positive) opening operation per EN 60947-5-1
- Compliant with ANSI B11.19, NFPA 79, and IEC/EN 60204-1 Emergency Stop requirements
- "Safe Break Action" ensures OSSDs turn off if the contact block is separated from the actuator
- 8-pin M12 quick disconnect
- Armed state indication options include YELLOW, GREEN or no indication (OFF), depending on model
- All models illuminate with flashing red when actuated (button pushed)
- "Emergency Stop" legend included
- Two, solid-state, PNP current sourcing OSSD outputs
- In-Series Diagnostic (ISD) for button health and status information when used with a compatible Banner Safety Controller
- All models have a 40 mm "mushroom style" push button

1.1 Models

Model	Mounting Style	Reset Function	Armed Illumination Color
SSA-EB1PLYR-0DECQ8	30 mm	No	Yellow
SSA-EB1PLXR-0DECQ8			None
SSA-EB1PLGR-0DECQ8			Green
SSA-EB1PLYR-0DECQ8R		Yes	Yellow
SSA-EB1PLXR-0DECQ8R			None
SSA-EB1PLGR-0DECQ8R			Green
SSA-EB1PLYR-0DED1Q8	Flush	No	Yellow
SSA-EB1PLXR-0DED1Q8			None
SSA-EB1PLGR-0DED1Q8			Green
SSA-EB1PLYR-0DED1Q8R		Yes	Yellow
SSA-EB1PLXR-0DED1Q8R			None
SSA-EB1PLGR-0DED1Q8R			Green

1.2 Important... Read this before proceeding!

The user is responsible for satisfying all local, state, and national laws, rules, codes, and regulations relating to the use of this product and its application. Banner Engineering Corp. has made every effort to provide complete application, installation, operation, and maintenance instructions. Please contact a Banner Applications Engineer with any questions regarding this product.

The user is responsible for making sure that all machine operators, maintenance personnel, electricians, and supervisors are thoroughly familiar with and understand all instructions regarding the installation, maintenance, and use of this product, and with the machinery it controls. The user and any personnel involved with the installation and use of this product must be thoroughly familiar with all applicable standards, some of which are listed within the specifications. Banner Engineering Corp.

makes no claim regarding a specific recommendation of any organization, the accuracy or effectiveness of any information provided, or the appropriateness of the provided information for a specific application.

**WARNING:**

- **Not a safeguarding device**
- Failure to follow these instructions could result in serious injury or death.
- This device is not considered a safeguarding device because it requires an overt action by an individual to stop machine motion or hazards. A safeguarding device limits or eliminates an individual's exposure to a hazard without action by the individual or others. This device cannot be substituted for required safeguarding. Refer to the applicable standards to determine those requirements.

1.3 Emergency Stop Considerations

NFPA 79, ANSI B11.19, IEC/EN 60204-1, and ISO 13850 specify emergency stop requirements, including the following:

- Emergency-stop push buttons shall be located at each operator control station and at other operating stations where emergency shutdown is required.
- Stop and emergency-stop push buttons shall be continuously operable and readily accessible from all control and operating stations where located. Do not mute or bypass E-stop buttons.
- Actuators of emergency-stop devices shall be colored red. The background immediately around the device actuator shall be colored yellow (where possible). The actuator of a push-button-operated device shall be of the palm or mushroom-head type.
- The emergency-stop actuator shall be a self-latching type.

**WARNING:**

- **Do not mute or bypass any emergency stop device**
- Muting or bypassing the safety outputs renders the emergency stop function ineffective.
- ANSI B11.19, NFPA 79 and IEC/EN 60204-1 require that the emergency stop function remains active at all times.

**WARNING:**

- **Connect two or more devices to the same safety module (controller) in series**
- Connecting devices in parallel defeats the switch contact monitoring ability of the module and creates an unsafe condition that could result in serious injury or death.
- Failure to test each device individually in this manner could result in undetected faults and create an unsafe condition that could result in serious injury or death.
- Connect the contacts of the corresponding pole of each switch in series. Never connect the contacts of multiple switches in parallel. Individually actuate (engage) each device, then release (or re-arm) and reset the safety module. This allows the module to check each switch and its wiring to detect faults. Perform this check during the prescribed checkouts.

1.4 Overview

The SSA-EB1PLx-0Dx Series Lighted Emergency Stop Button with ISD is a mushroom-style electro-mechanical emergency stop push button. When the button is armed and the device input requirements are satisfied, the two, solid-state PNP output signal switching devices (OSSDs) are on (conducting). When the button is pushed, the OSSDs are off (not conducting). The OSSDs remain in this condition until the push button is manually re-armed by pulling or twisting clockwise the red push button actuator.

The SSA-EB1PLx-0Dx..ECQ.. series has a 30 mm mounting base similar to Banner's OTB, VTB, and STB Optical Touch Buttons for ease of mounting without requiring an additional enclosure. The SSA-EB1PLx-0Dx..ED1Q.. series has a flat mounting base for ease of mounting without requiring an additional enclosure.

The illumination provides easy identification of a pushed/actuated button. An armed button will light a steady yellow or green illumination or be OFF (depending on model). A pushed/actuated button is indicated by a red flashing illumination. Internal or external faults are indicated by a double-flashing red illumination.

2 Installation Instructions

2.1 Mechanical Installation

The SSA-EB1PLx-0Dx Series Lighted Emergency Stop Button with ISD is supplied with all necessary mounting hardware.



Important: Install the emergency stop in a manner that discourages tampering or defeat. Mount emergency stops to prevent bypassing at the terminal chamber or quick disconnect (QD) connection.

The hardware supplied with the 30 mm mount SSA-EB1PLx-0Dx..ECQ.. series includes a jam nut, lock washer, lock ring, and seal washer. Use the lock ring to prevent rotation if a 5 mm keyway is provided in the 30 mm mounting hole. The threaded base contains external M30 threads for the supplied jam nut, as well as internal ½-14 NPSM threads for an alternate mounting option.

The hardware supplied with the flush mount SSA-EB1PLx-0Dx..ED1Q.. series includes four M5 screws and nuts.

Figure 3. Mounting the ..ECQ (30 mm) models

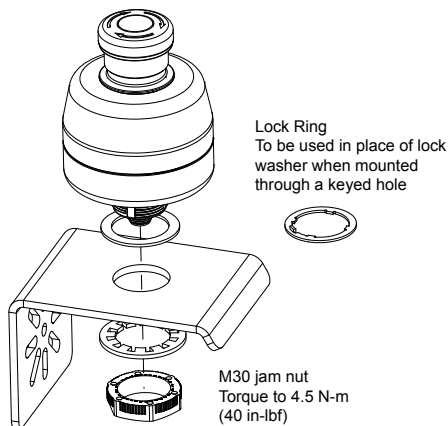
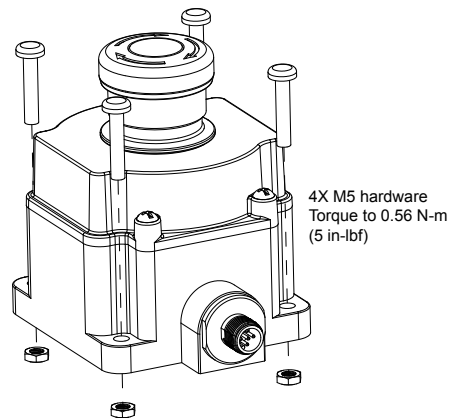

Figure 4. Mounting the ..ED1Q (flush mount) model



2.2 Installation Requirements

The device is intended for indoor use only and must not be affected by environmental conditions. Install the device so that operation is not impeded, but protected against inadvertent operation (for example, accidental actuation by being bumped or leaned against). Do not operate the switch using a tool. Do not expose the switch to excessive shocks and vibrations, otherwise the switch may be deformed or damaged, causing malfunction or operation failure.

Electrical installation must be made by qualified personnel¹ and must comply with NEC (National Electrical Code), NFPA 79 or IEC/EN 60204-1, and all applicable local standards. It is not possible to give exact wiring instructions for a device that interfaces to a multitude of machine control configurations. The following is general in nature; it is recommended to perform a risk assessment to ensure appropriate application, interfacing/connection, and risk reduction (see ISO 12100 or ANSI B11.0).



WARNING:

- **Risk of electric shock**
- Use extreme caution to avoid electrical shock. Serious injury or death could result.
- Always disconnect power from the safety system (for example, device, module, interfacing, etc.), guarded machine, and/or the machine being controlled before making any connections or replacing any component. Lockout/tagout procedures might be required. Refer to OSHA 29CFR1910.147, ANSI Z244-1, or the applicable standard for controlling hazardous energy.
- Make no more connections to the device or system than are described in this manual. Electrical installation and wiring must be made by a Qualified Person² and must comply with the applicable electrical standards and wiring codes, such as the NEC (National Electrical Code), NFPA 79, or IEC 60204-1, and all applicable local standards and codes.

¹ A person who, by possession of a recognized degree or certificate of professional training, or who, by extensive knowledge, training and experience, has successfully demonstrated the ability to solve problems relating to the subject matter and work.

² A person who, by possession of a recognized degree or certificate of professional training, or who, by extensive knowledge, training and experience, has successfully demonstrated the ability to solve problems relating to the subject matter and work.

2.3 Output Signal Switching Devices (OSSDs) and External Device Monitoring (EDM)

The SSA-EB1PLx-0Dx is able to detect faults on OSSD1 and OSSD2. These faults include short circuits to +24 V DC and 0 V, and between OSSD1 and OSSD2.

Both OSSD outputs must be connected to the machine control so that the machine's safety-related control system interrupts the circuit or power to the machine primary control element(s) (MPCE), resulting in a non-hazardous condition.

Final switching devices (FSDs) typically accomplish this when the OSSDs go to an OFF state.

Refer to the output specifications and these warnings before making OSSD output connections and interfacing the SSA-EB1PLx-0Dx to the machine.



WARNING:

- **Interfacing both output signal switching devices (OSSD)**
- Failure to follow these instructions could result in serious injury or death.
- Unless the same degree of safety is maintained, never wire an intermediate device(s) (PLC, PES, PC) between the safety module outputs and the master stop control element it switches such that a failure causes a loss of the safety stop command or the failure allows the safety function to be suspended, overridden, or defeated.
- Connect both OSSD outputs to the machine control so that the machine's safety-related control system interrupts the circuit to the machine primary control element(s), resulting in a non-hazardous condition.



WARNING:

- **Interfacing OSSD Outputs to Machine Inputs**
- Failure to properly interface the OSSD Outputs to the guarded machine could result in serious injury or death.
- To ensure proper operation, the Banner device output parameters and machine input parameters must be considered when interfacing the Banner device OSSD outputs to machine inputs. Design the machine control circuitry so that the maximum load resistance value is not exceeded and the maximum specified OSSD Off-state voltage does not result in an On condition.

External device monitoring (EDM) is a function used to monitor the state of the external, positively guided (mechanically linked) machine control contacts (Final Switching Devices (FSD) and/or MPCEs). The SSA-EB1PLx-0Dx does not include the EDM function. As a result, the SSA-EB1PLx-0Dx should be used with an external safety monitoring device that monitors the status of the two SSA-EB1PLx-0Dx OSSDs and is capable of providing the EDM function.

Examples of appropriate external safety monitoring devices include the Banner SC10-2ro Safety Controller.



WARNING:

- **The SSA-EB1PLx-0Dx does not have external device monitoring (EDM).**
- If EDM is required for the application, it must be implemented in the external control.

2.3.1 Fault-Tolerant Output Feature

Faults that do not immediately compromise the safe operation of the SSA-EB1PLx-0Dx (for example safety output to external potential, crosswire short safety output) result in a delayed switch-off of the safety outputs.

The safety outputs switch off when the error warning exceeds 20 minutes. In case of error warning, the E-stop will double-flash red.

Use this fault-tolerant output feature to run down the machinery in a controlled manner. After fixing the fault, the error message is confirmed by a voltage reset. The safe outputs enable and allow a restart.

Faults that directly affect the safe operation of the emergency stop device immediately cause a lockout condition and the OSSDs turn off.

2.4 Wiring for a Single E-Stop

Figure 5. Single SSA-EB1PLx-0Dx Series Lighted Emergency Stop Button with ISD with SC10-2ro.

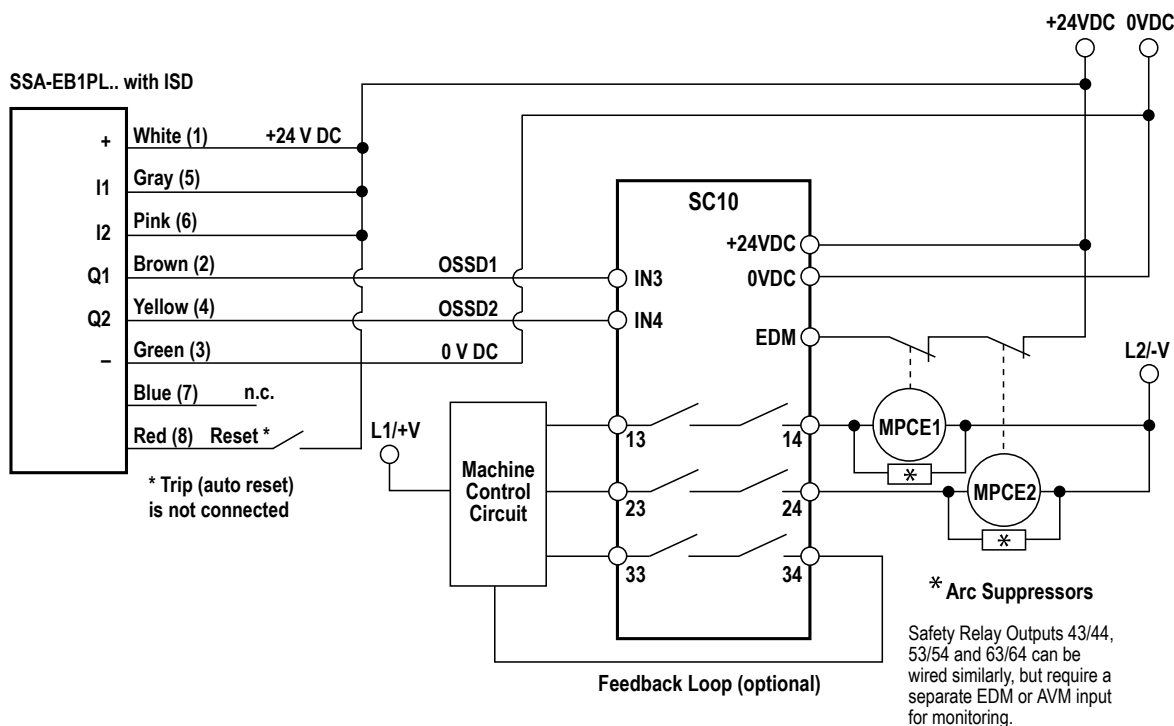

The SSA-EB1PLx-0Dx Series Lighted Emergency Stop Button with ISD can be connected in series or individually to a compatible Banner XS26-2 or SC10-2ro Safety Controller. See the XS26-2/SC10 Safety Controller Instruction Manual for additional details regarding input terminal combinations compatible with ISD.

2.4.1 Wire the Device in Series

To connect two or more SSA-EB1PLx-0Dx buttons in series, follow these steps.

1. Connect the safety outputs of the last emergency stop device to a safety monitoring unit.
2. Connect the safety inputs of the first emergency stop device of the series to + 24 V DC.
3. Connect the safety outputs of the first emergency stop device to the safety inputs of the second emergency stop (and second to third, etc).
4. When all the emergency stop devices are armed, the last emergency stop device of the series connection will turn on its safety outputs.
5. If you are using an optional In-Series Diagnostic (ISD) module (SI-RFA-DM1), integrate the diagnostic module between the last emergency stop device and the safety monitoring module in the series connection.
The status information can be retrieved from the diagnostic device.



Important: Verify the SSA-EB1PLx-0Dx emergency stop device and the safety monitoring module are powered from the same power supply or the commons of the separate supplies are the same.

Figure 6. Series connection of multiple SSA-EB1PLx-0Dx.. without reset function wiring diagram.

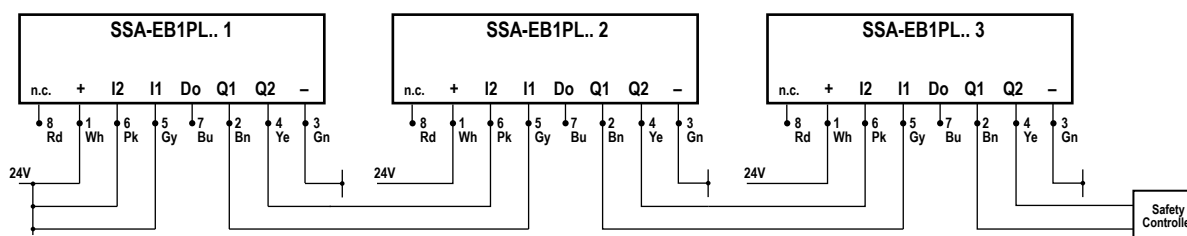
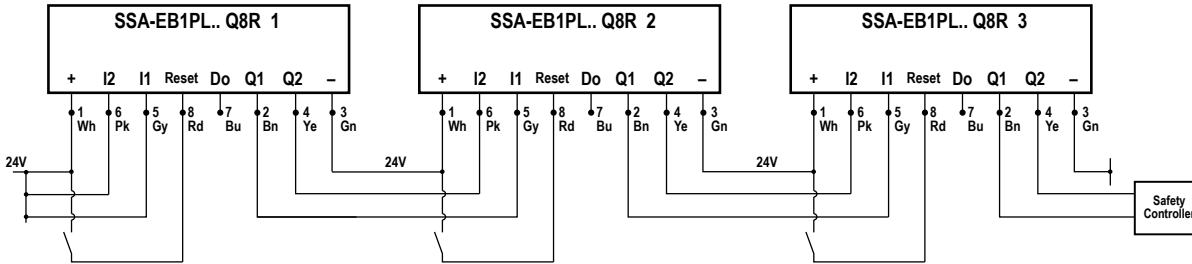

Figure 7. Series connection of multiple SSA-EB1PLx-0Dx..Q8R with reset function wiring diagram.



After the emergency device is rearmed, the optional reset function requires a manual acknowledgement before the safety output of the device is switched on (only that individual emergency stop device, not the entire chain).

2.4.2 Wire the Device in Series Using the Quick Disconnect (QD)

When connecting units in series, simplify the wiring using special t-adapters and low cost unshielded four-wire double-ended cables.

A similar configuration is shown except the connections are all made using quick disconnects. The SSA-EB1PLx-0Dx E-Stops, SI-RFD switches, and the SSA-ISD Connect can be combined in a single chain.

1. Connect the female 4-pin M12 cable to the male 4-pin M12 of the series connection t-adapter (**SI-RFA-TS**).
2. If a manual reset model emergency stop device is used, connect the female 8-pin M12 of the Reset T-Adapter (**SI-RFA-TK**) to the male 8-pin M12 connector of the series connection t-adapter. Connect a female 4-pin M12 cable to the male 4-pin M12 QD of the t-adapter for connected a reset switch.
3. Connect the SSA-EB1PLx-0Dx to the male 8-pin M12 connector of the t-adapter. Use **DEE2R-8xxD** extensions cables as needed.
4. Connect the male 4-pin M12 end of a double-ended cable to the female 4-pin M12 of the t-adapter. Connect the female 4-pin M12 end of the double ended cable to the next series connection t-adapter (**SI-RFA-TS**).
5. At the end of the line a terminating plug (**SI-RFA-P**) is required to properly truncate the system.
6. The wired end of the 4-pin M12 cable (from step 1) can be wired directly to a Safety Monitoring Module or can be wired through an In-Series Diagnostic (ISD) module then to the Safety Monitoring device.

Verify that the SSA-EB1PLx-0Dx and the safety monitoring module are powered from the same power supply or the commons of the separate supplies are the same. Ensure that the voltage level at SSA-EB1PLx-0Dx #1 (furthest from the power supply) is above 19.5 V for the system to operate properly.

Figure 8. SSA-EB1PLx-0Dx E-Stops with ISD Series Connection

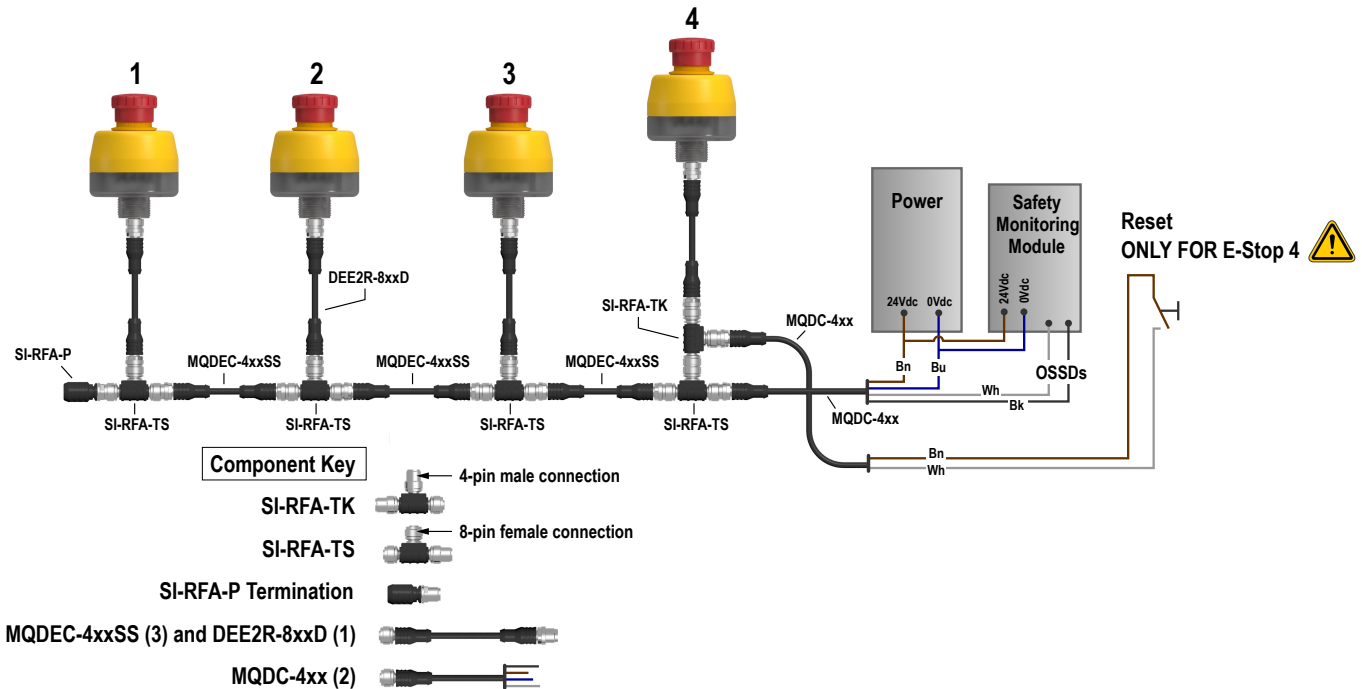

In a long series or series with many ISD devices, the voltage at all devices must stay above 19.5 V for proper operation.

An additional power supply may be required to maintain a minimum of 19.5 V at all devices. For examples of how to properly connect a second power supply, refer to [Figure 9](#) on p. 9 and [Figure 10](#) on p. 9.

For guidance on maximum total cable length and maximum number of devices before an additional power supply may be needed, refer to [Figure 11](#) on p. 10. For using ISD information to monitor the individual device voltages, see [In-Series Diagnostic \(ISD\) Information](#) on p. 11.

There are two options to connect an additional power supply.

Figure 9. Option 1: Use a **SI-RFA-TK** Reset Connector in series with ISD Device. If available, set the power supplies for parallel output.



Figure 10. Option 2: Replace the terminator with a power supply. The OSSD1 and OSSD2 wires at power supply #2 must be connected to +24 V DC. If available, set the power supplies for parallel output.



Figure 11. Maximum total cable length for a single power supply

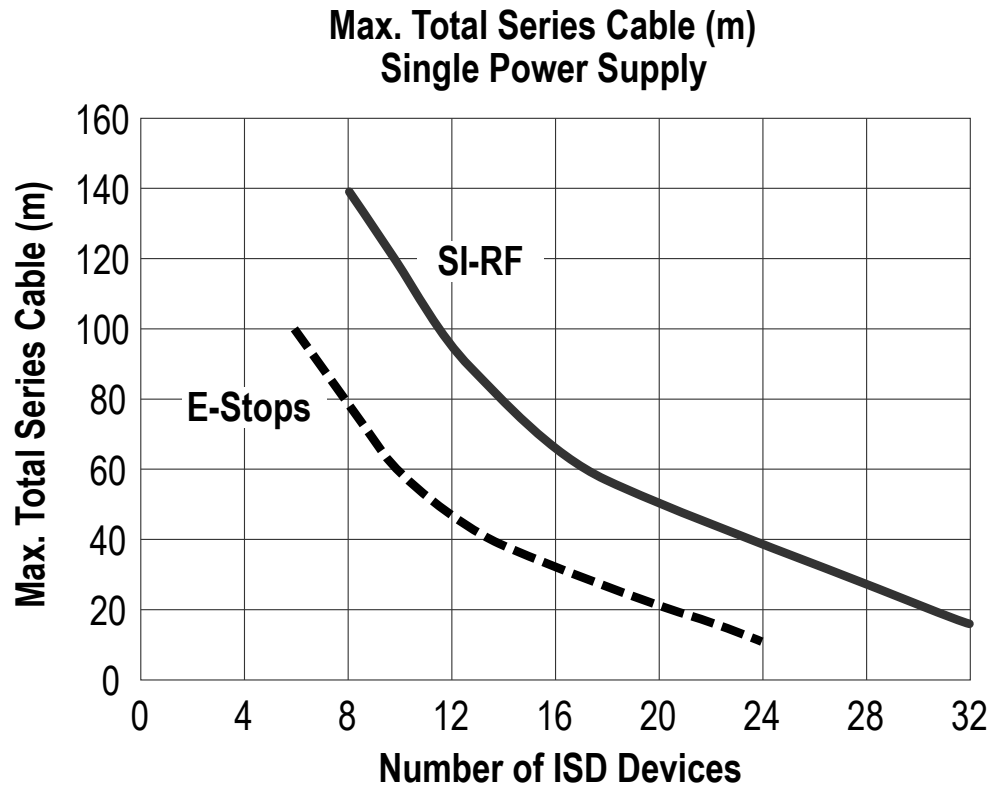

The SI-RFD switches and ISD Connect have similar current demands. However, when used with a number of lighted ISD emergency stop devices, the current draw of the emergency stop devices governs the cable lengths and when more power is needed.

**WARNING:**

- **Safety devices with OSSDs and without ISD, such as safety light curtains, are not compatible.**
- Failure to follow these instructions could result in serious injury or death.
- Do not use safety devices with OSSDs and without ISD in a series connection of multiple ISD devices.

2.5 Checkout

At machine set up, a *Designated Person*³ should test each safety point for proper machine shutdown response. A *Designated Person* should check the safety point for proper operation, physical damage, button looseness, and excessive environmental contamination. This should take place on a periodic schedule determined by the user, based on the severity of the operating environment and the frequency of switch actuations.

Adjust, repair, or replace components as needed. If inspection reveals contamination on the switch, thoroughly clean the switch and eliminate the cause of the contamination. Replace the switch and/or appropriate components when any parts or assemblies are damaged, broken, deformed, or badly worn; or if the electrical/mechanical specifications (for the environment and operating conditions) have been exceeded.

Always test the control system for proper functioning under machine control conditions after performing maintenance, replacing the safety point, or replacing any component of the device.

³ A *Designated Person* is identified in writing by the employer as being appropriately trained to perform a specified checkout procedure. A Qualified Person possesses a recognized degree or certificate or has extensive knowledge, training, and experience to solve problems relating to the emergency stop installation.

2.6 Resetting the Inputs

The reset function forces a local confirmation that the safety outputs are switched on after resetting the individual emergency stop button.

If an emergency stop button with a reset function is actuated and then armed/re-armed (pulled out), close and open the external reset switch within 0.25 seconds (minimum) to 1 second (maximum) to turn the e-stop buttons outputs on (assuming its inputs are satisfied).

The reset function only applies to the emergency stop button models with the reset functionality. This reset feature allows for a local reset at a given emergency stop button but does not allow for an entire safety system reset.

If a chain of ISD devices are cascaded (see [Wire the Device in Series](#) on p. 7), the reset function only applies to the individual emergency stop button (1, 2, or 3 but not the series). If emergency stop button 2 is actuated then armed/re-armed, engaging the external reset switch of emergency stop buttons 1 or 3 will have no effect. Only engaging the external reset switch of emergency stop button 2 switches the chain's outputs on.



CAUTION: When power is switched on and the emergency stop buttons are in the on (armed) position, the safety outputs of the emergency stop buttons with the reset function will switch on without activating the reset button.



WARNING:

- Use of Auto or Manual Restart
- Failure to follow these instructions could result in series injury or death.
- Applying power to the Banner device, returning the emergency stop to the armed position, or resetting a manual restart condition **MUST NOT** initiate dangerous machine motion.
- Design the machine control circuitry so that one or more initiation devices must be engaged (in a conscious act) and the Banner device must be in Run mode to start the machine.



2.7 In-Series Diagnostic (ISD) Information

The information transmitted via the In-Series Diagnostic (ISD) interface is not safety related. The diagnostic technology allows a wide range of device information to be loaded into the machine control system.

To interpret this information, Banner diagnostic modules are available, including the **SI-RF-DM1** and **-DM2** Diagnostic Modules and the **SC10-2roe** Safety Controller. Refer to the instruction manuals for detailed information on the diagnostic devices. By means of diagnostics, the following information can be transmitted, among others:

- Button Status (armed, off, faulted)
- Under-voltages in the series connection (chain)
- Attempts to remove buttons from the chain
- Wrong order of devices in the chain

At this time this information can be refined using the following interfaces:

- USB—Displays device information on the PC (requires using an **SI-RF-DM1** or **SC10-2roe** Safety Controller)
- IO-Link—Bus independent data reading into the control system (requires using the **SI-RF-DM1** or **SI-RF-DM2** Diagnostic Modules and an IO-Link master)
- Industrial Ethernet Protocols—Bus data reading into the control system (requires using the **SC10-2roe** Safety Controller)

2.8 Installing the Silicone Cover

To properly install the FDA-grade silicone cover and achieve an IEC IP69 rating, follow these instructions.

1. Turn the cover inside-out, except for the top portion the button fits into.
2. Place the cover on top of the emergency stop unit.
3. Roll the cover onto the e-stop unit.
4. Continue rolling the cover down, around the base of the e-stop unit, until the entire unit is covered.
5. Mount the e-stop and cover assembly to a bracket wide enough to cover the base of the assembly. The cover should be clamped firmly between the e-stop button and the bracket.



Note: This cover is suitable for applications with pull-to-release resetting methods.



Note: The FDA-grade silicone cover withstands high pressure, high temperature washdown, and increases the product rating to IEC IP69. The cover is ECOLAB® certified to withstand aggressive cleaning procedures with chemicals used in the food processing industry.

3 Specifications



Important: Connect the SSA-EB1PLx-0Dx Series Lighted Emergency Stop Button with ISD only to a SELV (Safety Extra-Low Voltage) for circuits without earth ground or a PELV (Protected Extra-Low Voltage) for circuits with earth ground power supply.

Rated Supply Voltage (Ue)

24 V DC + 15%, -20% (PELV/SELV power supply)
The external voltage supply must be capable of buffering brief mains interruptions of 20 ms, as specified in IEC/EN 60204-1.

Rated Isolation Voltage (Ui)

75 V DC

Rated Impulse Withstand Voltage (Uimp)

500 V

Rated Conditional Short-Circuit Current

100 A

No-load Current

100 mA typical at 24 V DC
120 mA maximum at 19.2 V DC

Power Up Delay

≤ 2 s

Response Time

40 ms maximum + (7 ms × number of following ISD devices)

Housing/Button (Flush mount models)

Polycarbonate/Polyamide #10 or M5 (M5 hardware included); maximum tightening torque: 0.56 N·m (5 in·lbf)
Connector assembly: Nickel-plated zinc die cast

EMC

According to EN 61326-1 and EN 61326-3-1

Safety Data

SIL 3 (IEC 61508)
SILCL 3 (EN 62061)
Category 4, PL e (EN ISO 13849-1)
PFH_D: 6.9×10^{-9} 1/h according to EN 62061
Service Life: 20 years
B10d: 100,000 cycles

Vibration Resistance

Operating extremes: 10 Hz to 500 Hz, amplitude 0.35 mm acceleration
50 m/s²

Operating Conditions

-25 °C to +50 °C (-13 °F to +122 °F)
45% to 85% relative humidity (no condensation)

Environmental Ratings

For Indoor Use Only
IEC IP65 (EN 60529)
For the 30 mm models only with cover model SSAEB1P-ECWC
installed: IEC IP67, IEC IP69 (EN 60529)

Certifications



UL certified to
NISD NISD7
E186238

OSSD Outputs

Two, solid-state, current sourcing PNP outputs
Switching element function: PNP, NO
Voltage level: according to Type 3 EN 61131-2
Maximum operating current: 30 mA
Leakage current: ≤ 1 mA DC
On-state voltage: ≥ U_e - 3 V
Protection: Sustained short-circuit and overload protection; thermal / digital (clocking)
Test pulse duration: 70 μs
Test pulse rate: 1 s

Reset Input (specific models)

High Signal: 10 to 30 V DC
Low Signal: 0 to 3 V DC

Housing/Button (30 mm models)

Polycarbonate/Polyamide threaded base has M30 × 1.5 external threads; maximum tightening torque: 4.5 N·m (40 in·lbf)
Connector assembly: Nickel-plated brass

Indication

(varies with model)
Yellow (590 nm), green (525 nm), red (618 nm)

Maximum Cable Length Between E-Stops

30 m

Required Overcurrent Protection



WARNING: Electrical connections must be made by qualified personnel in accordance with local and national electrical codes and regulations.

Overcurrent protection is required to be provided by end product application per the supplied table.
Overcurrent protection may be provided with external fusing or via Current Limiting, Class 2 Power Supply.
Supply wiring leads < 24 AWG shall not be spliced.
For additional product support, go to www.bannerengineering.com.

Supply Wiring (AWG)	Required Overcurrent Protection (Amps)
20	5.0
22	3.0
24	2.0
26	1.0
28	0.8
30	0.5

3.1 Dimensions

All measurements are listed in millimeters, unless noted otherwise.

Figure 12. 30 mm Models

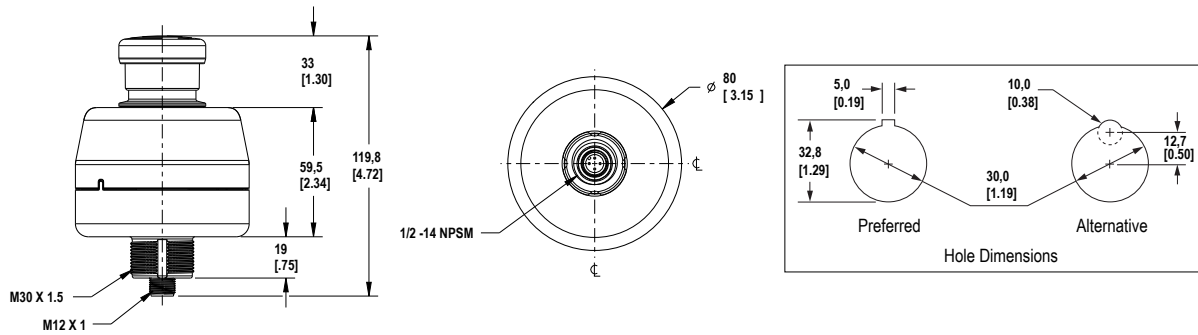

Figure 13. Washdown silicone cover SSA-EB1P-ECWC

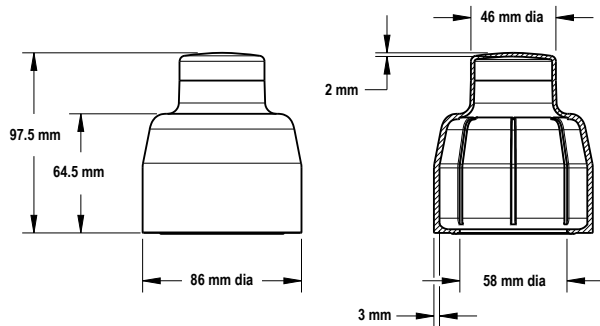
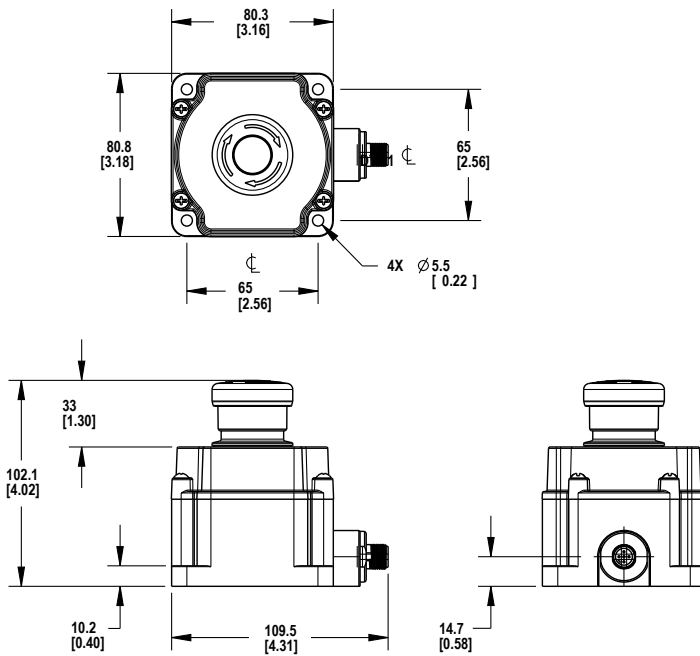
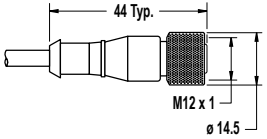
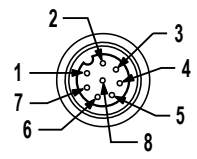

Figure 14. Flush mount models



4 Accessories

4.1 Cordsets

8-Pin Threaded M12 Cordsets—Flying Leads				
Model	Length	Style	Dimensions	Pinout (Female)
SXA-815D	4.57 m (15 ft)	Straight		 <p>1 = White 5 = Gray 2 = Brown 6 = Pink 3 = Green 7 = Blue 4 = Yellow 8 = Red</p>
SXA-825D	7.62 m (25 ft)			
SXA-850D	15.24 m (50 ft)			
SXA-8100D	30.48 m (100 ft)			

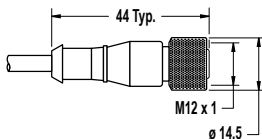
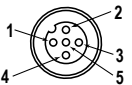
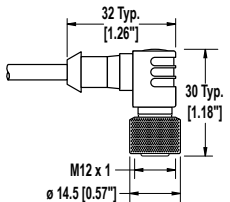
5-Pin Threaded M12 Cordsets—Single Ended				
Model	Length	Style	Dimensions	Pinout (Female)
MQDC1-501.5	0.5 m (1.5 ft)	Straight		 <p>1 = Brown 2 = White 3 = Blue 4 = Black 5 = Gray</p>
MQDC1-506	2 m (6.5 ft)			
MQDC1-515	5 m (16.4 ft)			
MQDC1-530	9 m (29.5 ft)			
MQDC1-506RA	2 m (6.5 ft)	Right-Angle		
MQDC1-515RA	5 m (16.4 ft)			
MQDC1-530RA	9 m (29.5 ft)			

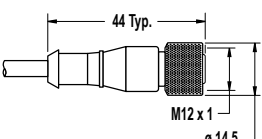
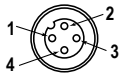
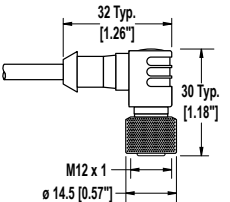
4-Pin Threaded M12 Cordsets—Single Ended				
Model	Length	Style	Dimensions	Pinout (Female)
MQDC-406	2 m (6.56 ft)	Straight		
MQDC-415	5 m (16.4 ft)			
MQDC-430	9 m (29.5 ft)			
MQDC-450	15 m (49.2 ft)			
MQDC-406RA	2 m (6.56 ft)	Right-Angle		<p>1 = Brown 2 = White 3 = Blue 4 = Black</p>
MQDC-415RA	5 m (16.4 ft)			
MQDC-430RA	9 m (29.5 ft)			
MQDC-450RA	15 m (49.2 ft)			

4-Pin Threaded M12 Cordsets—Double Ended				
Model	Length	Style	Dimensions	Pinout
MQDEC-401SS	0.31 m (1 ft)	Male Straight/ Female Straight		<p>Female</p> <p>Male</p> <p>1 = Brown 2 = White 3 = Blue 4 = Black</p>
MQDEC-403SS	0.91 m (2.99 ft)			
MQDEC-406SS	1.83 m (6 ft)			
MQDEC-412SS	3.66 m (12 ft)			
MQDEC-420SS	6.10 m (20 ft)			
MQDEC-430SS	9.14 m (30.2 ft)			
MQDEC-450SS	15.2 m (49.9 ft)			
MQDEC-403RS	0.91 m (2.99 ft)	Male Right-Angle/ Female Straight		<p>Female</p> <p>Male</p> <p>1 = Brown 2 = White 3 = Blue 4 = Black</p>
MQDEC-406RS	1.83 m (6 ft)			
MQDEC-412RS	3.66 m (12 ft)			
MQDEC-420RS	6.10 m (20 ft)			
MQDEC-430RS	9.14 m (30.2 ft)			
MQDEC-450RS	15.2 m (49.9 ft)			

8-Pin Threaded M12 Cordsets—Double Ended				
Model (8-pin/8-pin) ⁴	Length	Style	Dimensions	Pinout
DEE2R-81D	0.3 m (1 ft)	Female Straight/ Male Straight		<p>Female</p> <p>Male</p> <p>1 = White 2 = Brown 3 = Green 4 = Yellow 5 = Gray 6 = Pink 7 = Blue 8 = Red</p>
DEE2R-83D	0.91 m (3 ft)			
DEE2R-88D	2.44 m (8 ft)			
DEE2R-815D	4.57 m (15 ft)			
DEE2R-825D	7.62 m (25 ft)			
DEE2R-850D	15.24 m (50 ft)			
DEE2R-875D	22.86 m (75 ft)			
DEE2R-8100D	30.48 m (100 ft)			

⁴ Standard cordsets are yellow PVC with black overmold. For black PVC and overmold, add the suffix "B" to the model number (example, DEE2R-81DB)

4.2 Brackets

SSA-MBK-EEC1

- Single 30 mm hole
- 8 gauge steel, black finish (powder coat)
- Front surface for customer applied labels

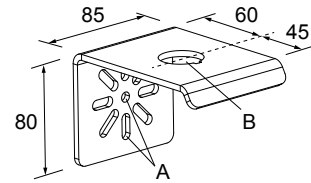

SSA-MBK-EEC2

- Two 30 mm holes
- 8 gauge steel, black finish (powder coat)
- Front surface for customer applied labels

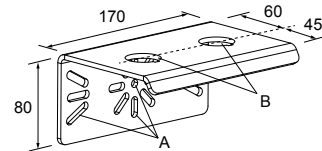

SSA-MBK-EEC3

- Three 30 mm holes
- 8 gauge steel, black finish (powder coat)
- Front surface for customer applied labels

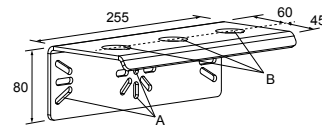

The SSA-MBK-EECx brackets offer:

- Horizontal and vertical (post) mounting
- Interchangeable positions of mounted devices (e.g. OTB/STB/VTB, E-Stop, K50s)

Hole size: A = $\varnothing 7$, B = $\varnothing 30$

4.3 Adapters and Other Accessories

Model	Description
SI-RFA-TS	SI-RF T-adapter for series connection, 4 pin to 8 pin to 4 pin, IP68 rated
SI-RFA-TK	SI-RF T-adapter for connection of the reset button, 8 pin to 4 pin to 8 pin, IP68 rated
SI-RFA-P	SI-RF Termination plug M12, IP68 rated
SI-RFA-DM1	SI-RF Diagnostic Module with 8 digital outputs and 1 diagnostic circuit Interfaces: IO-Link, USB 2.0
SI-RFA-DM2	SI-RF Diagnostic Module with 1 diagnostic circuit, IP69 rated Interfaces: IO-Link
SSA-EB1P-ECWC	FDA-grade silicone cover

4.4 Safety Controllers

Safety Controllers provide a fully configurable, software-based safety logic solution for monitoring safety and non-safety devices. For additional models and XS26 expansion modules, see instruction manual p/n [174868](#) (XS/SC26-2).

Non-Expandable Models	Expandable Models	Description
SC26-2	XS26-2	26 convertible I/O and 2 Redundant Solid State Safety Outputs
SC26-2d	XS26-2d	26 convertible I/O and 2 Redundant Solid State Safety Outputs with Display
SC26-2e	XS26-2e	26 convertible I/O and 2 Redundant Solid State Safety Outputs with Ethernet
SC26-2de	XS26-2de	26 convertible I/O and 2 Redundant Solid State Safety Outputs with Display and Ethernet
SC10-2roe		10 Inputs, 2 redundant relay safety outputs (3 contacts each) (ISD compatible)

4.5 Universal (Input) Safety Modules

UM-FA-xA Safety Modules provide forced-guided, mechanically-linked relay (safety) outputs for the SSA-EB1PLx-0Dx system when an external manual reset (latch) is desired or external device monitoring is required in the application. See datasheet p/n [141249](#) for more information.

Model	Description
UM-FA-9A	3 normally open (N.O.) redundant-output 6 amp contacts
UM-FA-11A	2 normally open (N.O.) redundant-output 6 amp contacts, plus 1 normally closed (N.C.) auxiliary contact

4.6 Pre-Installed Shroud

To order a unit with a shroud (model **ESC-1-YW**) pre-installed, the model number has an **S1** inserted after the LED color characters (for example, **SSA-EB1PLYR-0DED1Q8** becomes **SSA-EB1PLYRS1-0DED1Q8**). Contact Banner Engineering for availability.

Figure 15. SSA-EB1 PLXXS1 12ECQ8
E-Stop with a Shroud

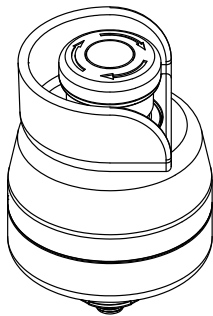

Figure 16. Dimensions for the SSA-EB1 PLXXS1 12ECQ8 E-stop button with shroud

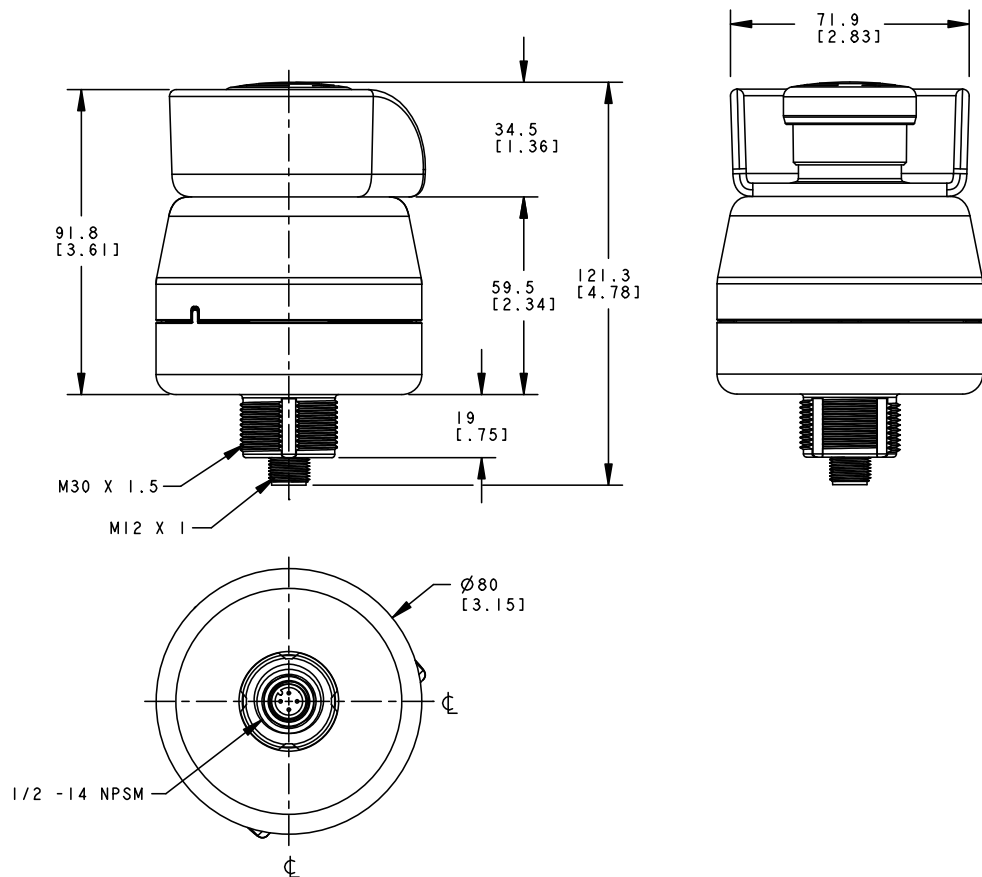

Figure 17. SSA-EB1P PLS1 E-Stop with Shroud

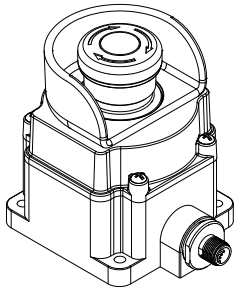
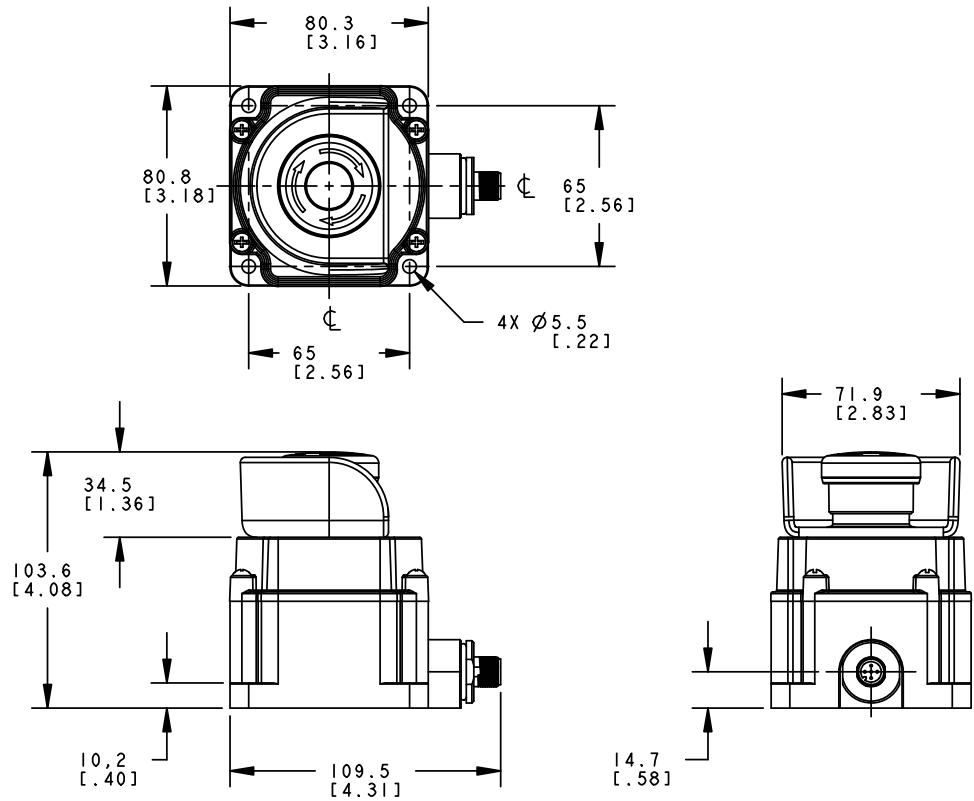

Figure 18. Dimensions for the SSA-EB1P PLS1 E-stop with shroud



5 Product Support and Maintenance

5.1 Maintenance and Service

Do not use alcoholic cleaning agents.

The SSA-EB1PLx-0Dx is maintenance-free.

For long-term and trouble-free operation, please periodically check the following points:

- solid fit of all components
- reliable switching function
- if damage occurs, please exchange the relevant components

Liability disclaimer— By breach of the given instructions (concerning the intended use, the safety instructions, the installation and connection through qualified personnel and the testing of the safety function) manufacturer's liability expires.

5.2 Status Indicators

Operating Mode	OSSD Inputs	Indication	OSSD Outputs
Power-up	X	Armed color (yellow, green or off, depending on the model) on for 0.5 s Red on for 0.5 s Off for 0.5 s minimum	OFF
Armed (button not pressed)	ON	Yellow, green, or off (depending on the model)	ON
Actuated (button pressed)	X	Flashing red	OFF
Re-armed, reset needed (specific models)	ON	Red	OFF
Armed	OFF	Armed indication (yellow, green or off, depending on the model)	OFF
Fault detected (non-critical)	X	Double flash red	ON
Fault detected (critical)	X	Double flash red	OFF

Faults that do not immediately compromise the safe operation of the emergency stop device (for example safety output to external potential, crosswire short safety output) result in a delayed switch-off of the OSSDs. The OSSDs will turn off when the error warning exceeds 20 minutes. See [Fault-Tolerant Output Feature](#) on p. 6 for more details.

5.3 EU Declaration of Conformity (DoC)

Banner Engineering Corp. herewith declares that these products are in conformity with the provisions of the listed directives and all essential health and safety requirements have been met. For the complete DoC, please go to www.bannerengineering.com.

Product	Directive
SSA-EB1PLx-0Dx Series Lighted Emergency Stop Button with ISD	Machinery Directive 2006/42/EC

Representative in EU: Peter Mertens, Managing Director, Banner Engineering BV. Address: Park Lane, Culliganlaan 2F, bus 3, 1831 Diegem, Belgium.

5.4 Information Available Using ISD

Obtain the following information from the ISD chain and a diagnostic unit or an ISD-enabled Safety Controller.

Cyclic Data about the Chain		
Short Name	Data Format	Description
Count mismatch	1/0	The number of devices in chain does not match configuration
Order mismatch	1/0	The order of devices in the chain does not match the configuration

Cyclic Data about the Chain		
Short Name	Data Format	Description
No ISD data detected	1/0	No (or corrupted) ISD data being transmitted (being received by diagnostic device)
Incompatible device	1/0	The chain or a unit in the chain has data but not ISD data
ISD detected not configured	1/0	ISD data detected on inputs that are not configured as ISD input
Terminator missing	1/0	Terminator plug not present (or inputs to first device low)
Actuator not taught	1/0	Not applicable
Wrong actuator detected	1/0	Not applicable
Internal unit error	1/0	A unit in the chain has an internal error
Output fault detected	1/0	A unit in the chain has an output fault and will turn off after the switch off delay period

Individual Unit Data - Flags		
Short Name	Data Format	Description
Actuator detected	1/0	Not applicable
Wrong actuator detected/Button armed	1/0	E-stop button is in the run state
Sensor not paired	1/0	Not applicable
Output 1	1/0	Output 1 is on
Output 2	1/0	Output 2 is on
Marginal range/Button armed	1/0	E-stop button is in the run state
Input 1	1/0	ISD device input 1 is on
Input 2	1/0	ISD device input 2 is on
Local reset expected	1/0	An ISD device with the latch feature requires a reset
Operating voltage warning	1/0	Voltage to the ISD device is at the limit of specifications
ISD data error	1/0	ISD error bit, corrupted data was received from the SI-RF ISD chain of switches.
Safety input fault	1/0	The system detected a fault on a safety input of an ISD device, power cycle required
Output error	1/0	ISD Device detects an output short to voltage or ground. This starts the "switch-off timer" counter.
Operating voltage error	1/0	Voltage to the ISD Device is above (over 30 V DC) or below (less than 19.2 V DC) limit of range.
Power cycle required	1/0	ISD Device detects a fault, a power cycled required.

Individual Unit Data - Configuration		
Short Name	Data Format	Description
Local reset unit	1/0	The ISD Device includes the latch feature
High coding level	1/0	Not applicable
Cascadable	1/0	The ISD Device includes the cascade feature Note: This will always be true for Emergency Stop models with ISD.
Fault tolerant outputs	1/0	Indicates that the ISD Device includes the fault tolerant output feature where output faults cause a 20 minute off delay/fault delay. Note: This will always be true for Emergency Stop models with ISD.

Individual Unit Data - Values		
Short Name	Data Format	Description
Device		Type of ISD Device

Individual Unit Data - Values		
Short Name	Data Format	Description
Expected code		Not applicable
Received code		Not applicable
Teach-ins remaining	number	Not applicable
Number of voltage errors	number	The number of voltage warnings received in the last 60 seconds (voltage is checked every second), a number between 0 and 60
Number of operations	number	The number of on/off cycles the device has experienced
Output switch-off time	number	The delay counter for certain output faults (0 - inactive, 20 to 1 - remaining minutes to device lockout state)
Range warning count	number	Not applicable
Supply voltage	number	The actual input voltage detected by the ISD device.
Internal temperature	number	The internal temperature of the ISD device (°C)
Actuator distance	number	Not applicable
Expected company name		Not applicable, value of 6 will be received
Received company name		Not applicable, this is the code received from an actuator (for RFID switches)

5.5 Contact Us

Banner Engineering Corp. headquarters is located at:

9714 Tenth Avenue North
Minneapolis, MN 55441, USA
Phone: + 1 888 373 6767

For worldwide locations and local representatives, visit www.bannerengineering.com.

5.6 Banner Engineering Corp. Limited Warranty

Banner Engineering Corp. warrants its products to be free from defects in material and workmanship for one year following the date of shipment. Banner Engineering Corp. will repair or replace, free of charge, any product of its manufacture which, at the time it is returned to the factory, is found to have been defective during the warranty period. This warranty does not cover damage or liability for misuse, abuse, or the improper application or installation of the Banner product.

THIS LIMITED WARRANTY IS EXCLUSIVE AND IN LIEU OF ALL OTHER WARRANTIES WHETHER EXPRESS OR IMPLIED (INCLUDING, WITHOUT LIMITATION, ANY WARRANTY OF MERCHANTABILITY OR FITNESS FOR A PARTICULAR PURPOSE), AND WHETHER ARISING UNDER COURSE OF PERFORMANCE, COURSE OF DEALING OR TRADE USAGE.

This Warranty is exclusive and limited to repair or, at the discretion of Banner Engineering Corp., replacement. **IN NO EVENT SHALL BANNER ENGINEERING CORP. BE LIABLE TO BUYER OR ANY OTHER PERSON OR ENTITY FOR ANY EXTRA COSTS, EXPENSES, LOSSES, LOSS OF PROFITS, OR ANY INCIDENTAL, CONSEQUENTIAL OR SPECIAL DAMAGES RESULTING FROM ANY PRODUCT DEFECT OR FROM THE USE OR INABILITY TO USE THE PRODUCT, WHETHER ARISING IN CONTRACT OR WARRANTY, STATUTE, TORT, STRICT LIABILITY, NEGLIGENCE, OR OTHERWISE.**

Banner Engineering Corp. reserves the right to change, modify or improve the design of the product without assuming any obligations or liabilities relating to any product previously manufactured by Banner Engineering Corp. Any misuse, abuse, or improper application or installation of this product or use of the product for personal protection applications when the product is identified as not intended for such purposes will void the product warranty. Any modifications to this product without prior express approval by Banner Engineering Corp will void the product warranties. All specifications published in this document are subject to change; Banner reserves the right to modify product specifications or update documentation at any time. Specifications and product information in English supersede that which is provided in any other language. For the most recent version of any documentation, refer to: www.bannerengineering.com.

For patent information, see www.bannerengineering.com/patents.