

Accessories
Compression Fitting
For Temperature Sensors
CF-M-6.35-G1/2-A4

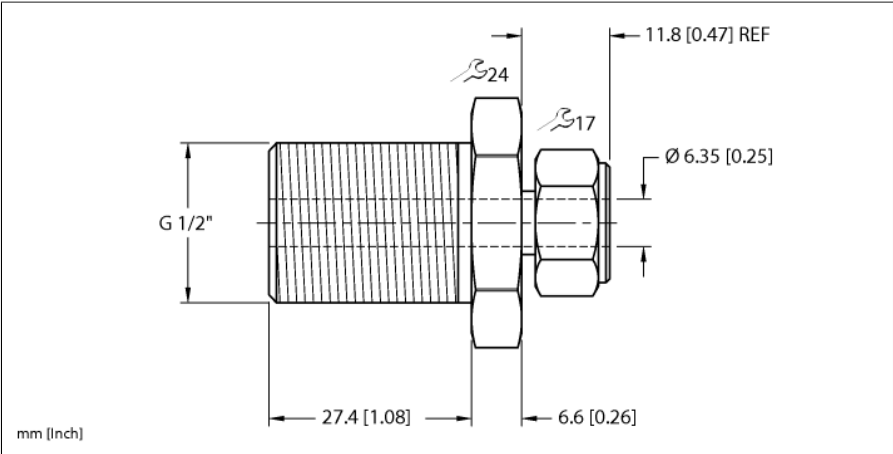

- Compression fittings for direct mounting of TP temperature probes
- Metal compression fitting
- For probe with 6.35-mm diameter
- G1/2" process connection, male thread

General description

With compression fittings, probes can be mounted directly where they are needed and they can be immersed as deep as wanted. Through direct contact with the medium, they react immediately to temperature changes.

| | |
|---------------------------------------|-------------------------------------|
| Type | CF-M-6.35-G1/2-A4 |
| ID | 100027547 |
| Temperature range | |
| Mechanical data | |
| Housing material | Stainless steel, 1.4404 (AISI 316L) |
| Sealing material | stainless steel |
| Process connection | G 1/2" male thread |
| Pressure resistance | 100 bar |
| Max. tightening torque of housing nut | 100 Nm |