

RM-29S10S-9A28B-R3M12

Absolute Rotary Encoder - Multiturn

Industrial Line

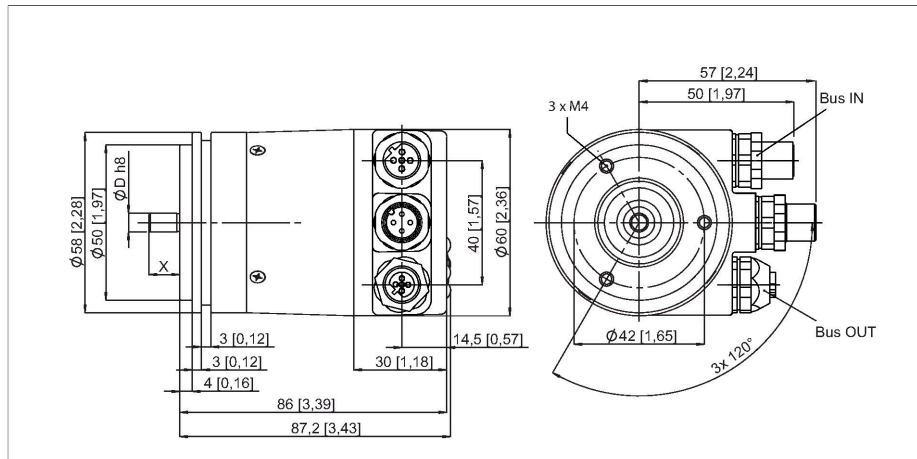

Features

- Synchro flange, Ø 58 mm
- Solid shaft, Ø 10 mm × 20 mm
- Optical measuring principle
- Shaft material: stainless steel
- Protection class IP67 on shaft side
- -40...+80 °C
- Max. 3000 rpm
- Profibus
- Removable bus cover with male, 3 × M12
- Singleturn, resolution scalable to 16 bit (default 13-bit)
- Multiturn resolution max. 12 bit, scalable

Technical data

Type	RM-29S10S-9A28B-R3M12
Ident. no.	1544418
Measuring principle	Photoelectric
Max. Rotational Speed	3000 rpm
Moment of inertia of the rotor	4 x10 ⁻⁶ kgm ²
Starting torque	< 0.01 Nm
Ambient temperature	-40...+80 °C
Operating voltage	10...30 VDC
No-load current	≤ 120 mA
Wire breakage/Reverse polarity protection	yes
Communication protocol	PROFIBUS-DP
Output type	absolute multiturn
Resolution single-turn	16 Bit
Resolution multiturn	12 Bit
	single-turn scalable
Design	Solid shaft
Flange type	Synchro flange
Flange diameter	Ø 58 mm
Shaft Type	Solid shaft
Shaft diameter D (mm)	10
Shaft length X	20 mm
Shaft material	Stainless steel
Housing material	Die-cast zinc
Electrical connection	Bus connection
	3 x M12
Axial shaft load	40 N

Wiring diagram

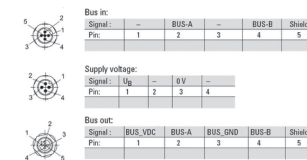

Technical data

Radial shaft load	80 N
Vibration resistance (EN 60068-2-6)	100 m/s ² , 55...2000 Hz
Shock resistance (EN 60068-2-27)	2500 m/s ² , 6 ms
Protection class housing	IP67
Protection class shaft	IP67

Signal	PB_A	PB_B	Shield	BUS_VDC	PB_A	BUS_GND	PB_B	Shield	-
Signal -Pin	BUS in 2	BUS in 4	BUS in 5	BUS out 1	BUS out 2	BUS out 3	BUS out 4	BUS out 5	-
Power	U _B	-	0V	-	-	-	-	-	-
Power- Pin	1	2	3	4	5	-	-	-	-