

# LI200P1-Q17LM1-LIU5X2

## Inductive Linear Position Sensor

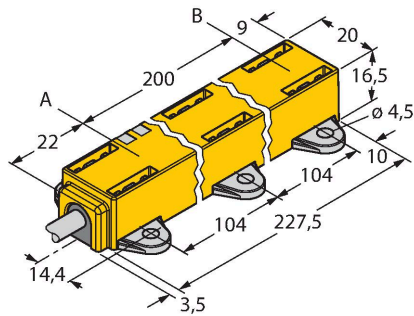

### Features

- Rectangular, plastic
- Many mounting possibilities
- Positioning element P1-Li-QR14/Q17L, mounting aids M1.1-Q17L and M1.2-Q17L included in delivery
- LED indicates measuring range
- Immune to electromagnetic interference
- Extremely short blind zones
- Resolution, 12-bit
- 4-wire, 15...30 VDC
- Analog output
- Programmable measuring range
- 0...10 V and 4...20 mA
- Cable connection

### Technical data

|   |                            |
|---|----------------------------|
| Type                                      | LI200P1-Q17LM1-LIU5X2      |
| ID  | 1590732                    |
| Measuring principle                       | Inductive                  |
| <b>General data</b>                       |                            |
| Measuring range                           | 200 mm                     |
| Resolution                                | 0.049 mm/12 bit            |
| Nominal distance                          | 1.5 mm                     |
| Blind zone a                              | 22 mm                      |
| Blind zone b                              | 9 mm                       |
| Repeat accuracy                           | ≤ 0.03 % of full scale     |
| Linearity deviation                       | ≤ 0.5 % f.s.               |
| Temperature drift                         | ≤ ± 0.01 %/K               |
| Hysteresis                                | not applied                |
| <b>Electrical data</b>                    |                            |
| Operating voltage                         | 15...30 VDC                |
| Residual ripple                           | ≤ 10 % $U_{ss}$            |
| Isolation test voltage                    | ≤ 0.5 kV                   |
| Short-circuit protection                  | yes                        |
| Wire breakage/Reverse polarity protection | yes / yes (voltage supply) |
| Output function                           | 4-wire, Analog output      |
| Voltage output                            | 0...10 V                   |
| Current output                            | 4...20 mA                  |
| Load resistance voltage output            | ≥ 4.7 kΩ                   |
| Load resistance current output            | ≤ 0.4 kΩ                   |
| Sample rate                               | 700 Hz                     |
| Current consumption                       | < 50 mA                    |

### Wiring diagram

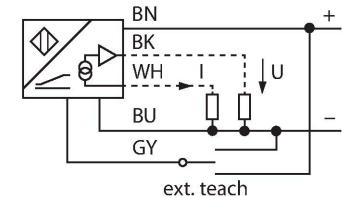

### Functional principle

The measuring principle of linear position sensors is based on RLC coupling between the positioning element and the sensor, whereby an output signal is provided proportional to the position of the positioning element. The rugged sensors are wear and tear-free, thanks to the contactless operating principle. They convince through their excellent repeatability, resolution and linearity within a broad temperature range. The innovative technology ensures a high immunity to electromagnetic DC and AC fields.

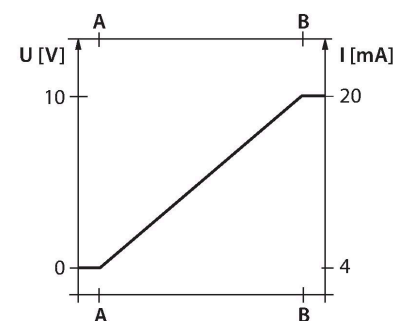

## Technical data

| Mechanical data          |   |
|--------------------------|---|
| Design                   | Profile, Q17L   |
| Dimensions               | 231 x 20 x 16.5 mm  |
| Housing material         | Plastic, PC-GF10  |
| Electrical connection    | Cable   |
| Cable quality            | Ø 5.2 mm, Black, LiFY, PVC, 2 m                           |
| Core cross-section       | 5 x 0.25 mm <sup>2</sup>                                  |
| Environmental conditions |   |
| Ambient temperature      | -25...+70 °C  |
| Vibration resistance     | 55 Hz (1 mm)  |
| Shock resistance         | 30 g (11 ms)  |
| Protection class         | IP67  |
| MTTF                     | 138 years acc. to SN 29500 (Ed. 99) 40 °C                 |
| Power-on indication      | LED, Green  |
| Measuring range display  | multifunction LED, green                                  |
| Included in delivery     | positioning element P1-Li-QR14/Q17L, M1.1-Q17L, M1.2-Q17L |

## Mounting instructions

### Mounting instructions/Description

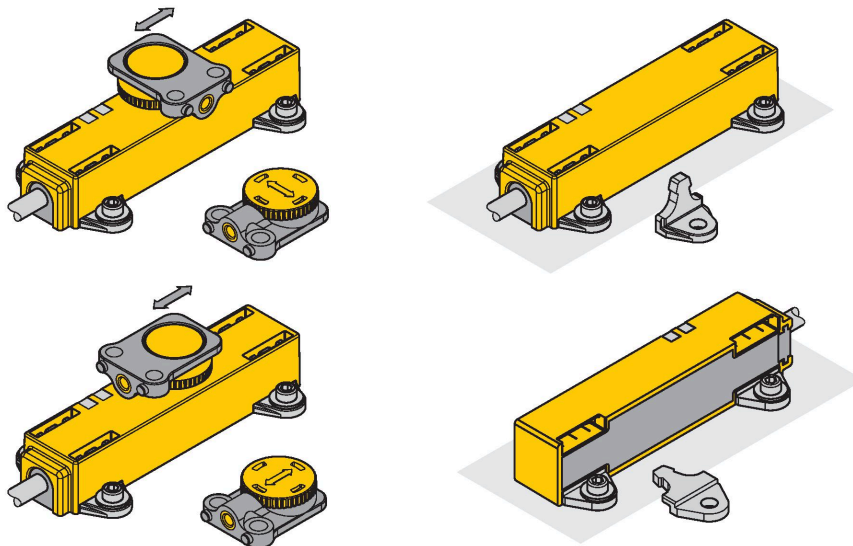

Extensive mounting accessories provide various options for installation. The positioning element can be mounted offset by 90°, thereby providing optimal mounting flexibility. The linear position sensor can also be safely and easily mounted offset by 90° using the two versions of the provided fastening units. The measuring principle of RLC coupling makes the sensor immune to magnetized ferrous chips and other interference fields.

Status display via LED

Green:

Sensor is supplied properly

Measuring range display via LED

Green:

Positioning element is within the measuring range

Green flashing:

Positioning element is within the measuring range, low signal quality (e.g. distance too great)

Off:

Positioning element is outside the detection range

Teaching

The start and end point of the measuring range are set by pressing the button on the teach adapter. Moreover there is the possibility of inverting the course of the output curve.

Bridge pin 5 and pin 1 for 10 s (UB) = factory setting

Bridge pin 5 and pin 3 for 10 s (GND) = factory setting inverted

Bridge pin 5 and pin 3 for 2 s (GND) = sets start value of measuring range

Bridge pin 5 and pin 1 for 2 s (UB) = sets end value of measuring range

## Accessories

P1-LI-QR14/Q17L

1590724

Floating positioning element for linear position sensors LI-QR14 and LI-Q17L; transverse and longitudinal mounting possible; the nominal distance to the sensor is 1.5 mm; pairing with the linear position sensor at a distance of up to 3 mm or a misalignment tolerance of up to 3 mm

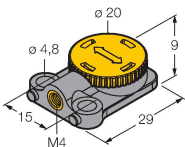

M1.1-Q17L

1590749

Mounting bracket for linear position sensors LI-Q17L; material: aluminum; 3 pcs. per bag

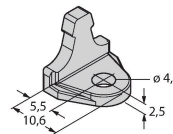

M1.2-Q17L

1590750

Mounting foot for linear position sensors LI-Q17L; material: aluminum; 3 pcs. per bag

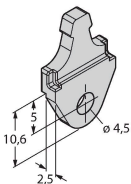

RMT-Q17L

1590755

Removal tool for mounting elements for linear position sensors LI-Q17L

