

# VS8LEJQ

## Photoelectric Sensor – Opposed Mode Sensor, Laser Emitter

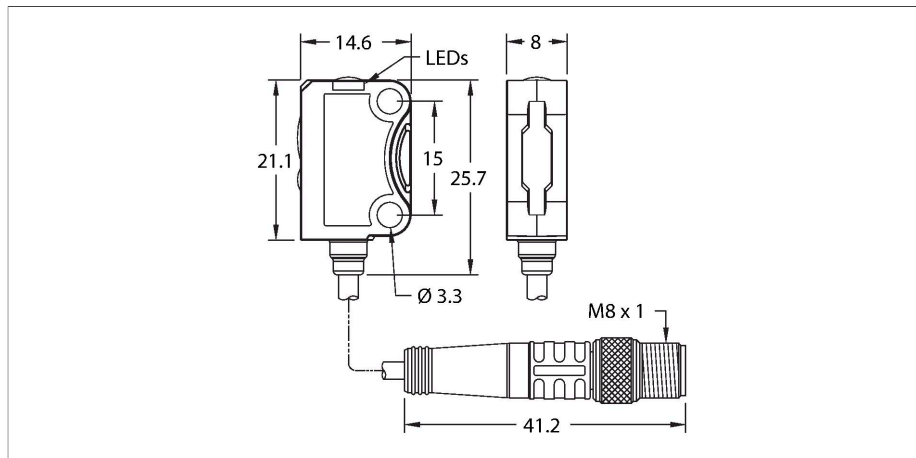

### Technical data

Type	VS8LEJQ
ID	3803483
<b>Optical data</b>	
Function	Opposed mode sensor
Operating mode	Laser Emitter
Light type	Red
Wavelength	655 nm
Laser class	▲ 1
Range	0...3000 mm
<b>Electrical data</b>	
Operating voltage	10...30 VDC
Residual ripple	< 10 % U <sub>ss</sub>
DC rated operational current	≤ 20 mA
Short-circuit protection	yes / Cyclic
Reverse polarity protection	yes
Readiness delay	≤ 300 ms
Response time typical	< 0.5 ms
<b>Mechanical data</b>	
Design	Rectangular, VS8
Dimensions	14.6 x 8 x 25.7 mm
Housing material	Plastic, PUR, Black
Lens	plastic, PMMA
Electrical connection	Cable with connector, M8 × 1, 0.2 m, PUR
Number of cores	4
Ambient temperature	-20...+50 °C
Protection class	IP67

### Features

- Connection via 200 m cable, PUR with M8 male connector
- Laser class 1, red
- Operating voltage: 10...30 VDC
- Laser LED can be switched off via input

### Wiring diagram

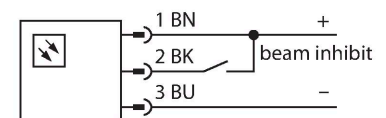

### Functional principle

These miniature photoelectric sensors in a rugged housing are ideal for detecting small parts in harsh environments. The bright and clearly visible light spots help with detecting extremely small objects. Devices with a blue emitter LED are also available, along with laser variants. The 4-pin devices all have a teach input that, in addition to the pushbutton on the devices, can be used to configure the sensor. This allows the switching point to be adjusted or the output behavior to be inverted. ECOLAB certification for devices with a cable connection rounds off the portfolio and allows use in cleanrooms or in the food industry.

Technical data

Power-on indication	LED, Green
Excess gain indication	LED
Tests/approvals	
Approvals	CE cULus

Accessories

SMBQ12A

3074341

Mounting bracket; material VA 1.4401, for photoelectric sensor, Q12 series

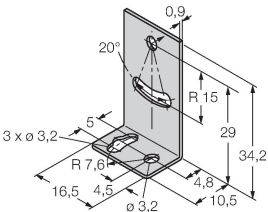

SMBQ12T

3073722

Mounting bracket; material VA 1.4401, for photoelectric sensor, Q12 series

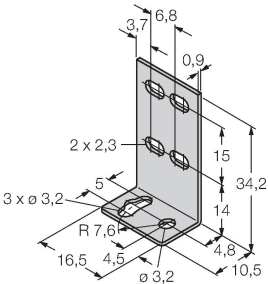

SMBVS8RA

3803492

Mounting bracket, for VS8 series sensors, angled, stainless steel

SMBVS8DT

3803493

Mounting clamp, plastic, black, for VS8 series sensors

Accessories

Dimension drawing	Type	ID	
	PKG4M-2/TXL	6625553	Connection cable, female M8, straight, 4-pin, cable length: 2 m, sheath material: PVC, black; cULus approval; other cable lengths and qualities available, see <a href="http://www.turck.com">www.turck.com</a>
	PKW4M-2/TXL	6625559	Connection cable, female M8, angled, 4-pin, cable length: 2 m, sheath material: PVC, black; cULus approval; other cable lengths and qualities available, see <a href="http://www.turck.com">www.turck.com</a>